



Haere-Mai, Slade, Oxwich, Swansea, SA3 1NA

Three Bedrooms
One Bathroom
Two Receptions

FREEHOLD

£699,995

1988sqft
0.42 Acres









Haere-Mai is a Māori expression of welcome – and the name is not lost on this wonderful Gower home with a current square footage of 1,988sqft and resting on a fabulous plot extending to 0.42acres.

Tucked into a lush and tranquil coastal setting, just a short stroll from the beach, Haere-Mai offers the kind of potential that rarely comes to market. With sea views, a large sun terrace, and beautiful grounds, it's a chance to create something truly special—whether through sensitive renovation or a bold new vision.

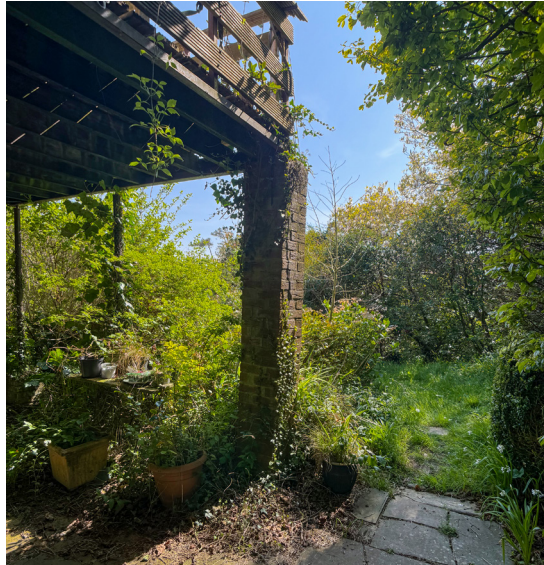



Haere-Mai presents a rare and compelling opportunity to secure an enviable slice of the Gower coast, just moments from the unspoilt sands of Slade Bay. Set in an elevated position and enveloped by mature gardens, this wonderfully private property offers peace, seclusion, and captivating sea views—a perfect canvas for a coastal retreat.

Occupying a generous 0.42-acre plot, the existing residence extends to approximately 1,988 sq ft and is arranged primarily above a substantial double garage/workshop. The current layout includes three bedrooms, two reception rooms, and a striking south-facing sun terrace that looks out to sea—an ideal vantage point for watching the sun trace its arc across the horizon.



While the house now requires modernisation, its scale, setting, and orientation offer enormous scope—whether through sensitive refurbishment or a bold new build project (subject to planning). The surroundings are serene and lush, with the garden offering both structure and potential, perfectly complementing the property's coastal charm.

Haere-Mai is a property for visionaries—an inspiring and increasingly rare chance to reimagine a home in one of the most sought-after and spectacular corners of the Gower Peninsula. With the beach a short stroll away and the wider coastline at your fingertips, this is the kind of lifestyle that rarely comes to market.





The property is connected mains services for water, electricity and sewerage and the central heating is fired by oil.

The Council tax is Band G (£3,571p.a.)

The EPC rating is E

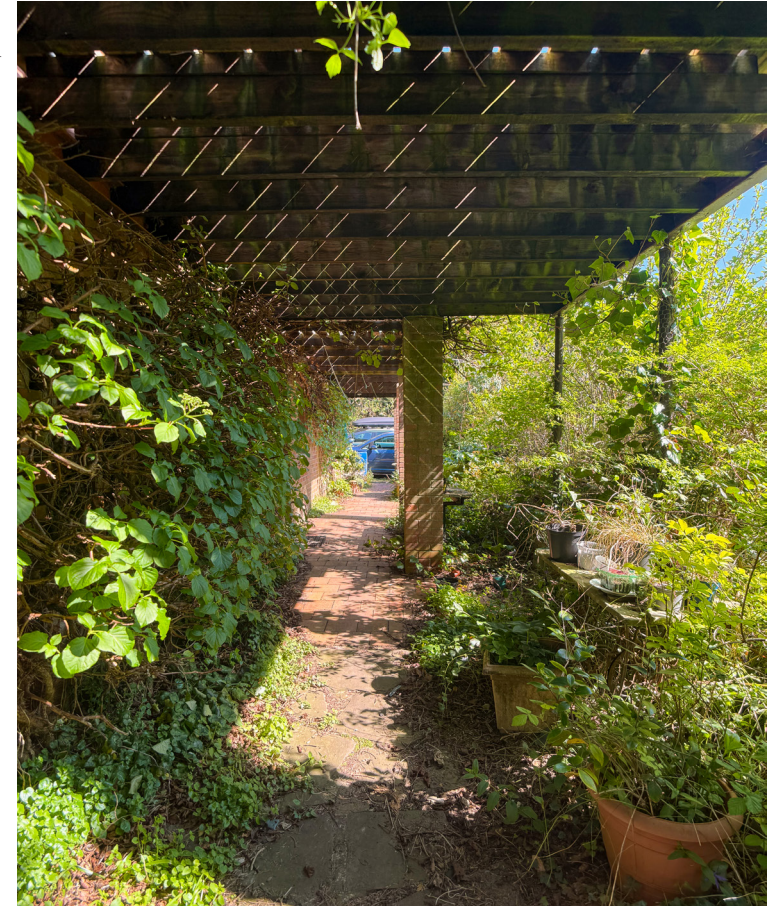

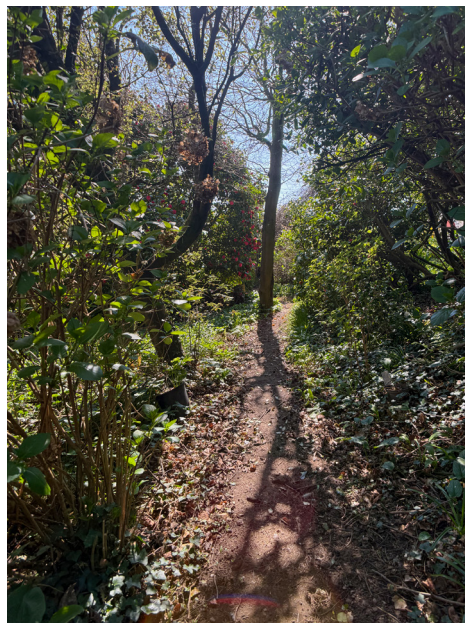
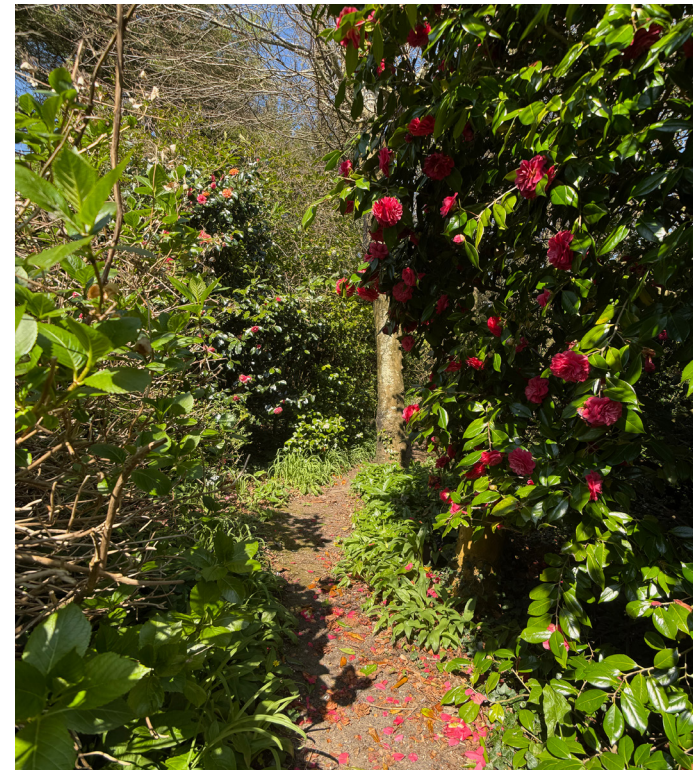

The Location

Living in Slade is about escaping the noise, slowing down, and surrounding yourself with natural beauty—yet never being far from Gower’s best offerings. Haere-Mai’s location is simply exceptional: a quiet coastal hamlet with unspoilt beach access and peaceful walking trails on your doorstep.

Beach Access: Slade Bay is just moments away—a quiet, often deserted beach with soft sand and clear water, ideal for swimming, kayaking, or simply unwinding.

Nearby Gower Gems: You’re just over a mile from Oxwich Bay, one of Gower’s most famous beaches, and within easy reach of Port Eynon, Three Cliffs, and Rhossili.

Walking & Nature: With footpaths running directly from the village and over the cliffs, this is a dream location for walkers and wildlife lovers alike.

Commuting:

Swansea City Centre is approximately 14 miles away (~35 minutes by car)

M4 Motorway (J47) is around 15 miles away (~40 minutes)

Shopping & Amenities:

Day-to-day needs can be met in Parkmill, Knelston, or Pennard

For wider shopping and dining options, Mumbles Village is about 11 miles away

Schools: The area falls within catchment for Knelston Primary School and Bishopston Comprehensive, both well-regarded locally.

Whether you’re looking for a private retreat, a bold self-build project, or simply the kind of coastal escape that rarely comes to market, Haere-Mai offers something truly special in a magical corner of South Wales.





Haere-Mai, Slade

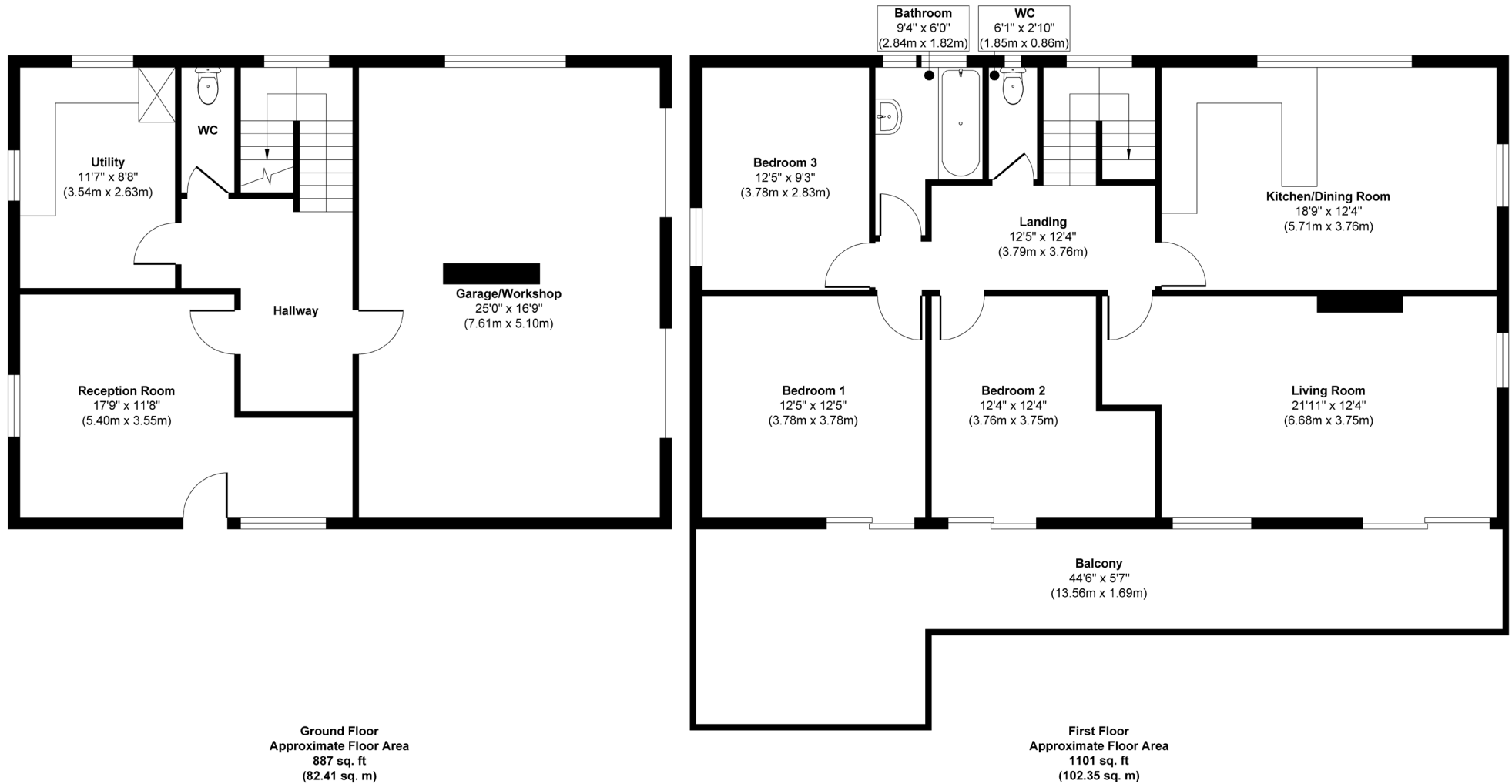

Approx. Gross Internal Floor Area 1988 sq. ft / 184.76 sq. m

Illustration for identification purposes only, measurements are approximate, not to scale.

Produced by Elements Property

THE
GREENROOM
ESTATE AGENCY

Telephone

01792 986099

Address

29-30 Dunns Lane
Mumbles
SA3 4AA

E-mail and Web

info@thegreenroomhomes.com
www.thegreenroomhomes.com.com